



# India's Most Active Seniors

 **ashiana**  
shubham

A joint project with **Arihant**

SENIOR LIVING AT CHENNAI



A joint project with **Arihant**

A joint venture (JV) between  
Arihant Group and  
JP Morgan Property Fund.

### About Ashiana Housing Limited:

- Over 35+ years of experience in real estate
- Pan India presence
- Pioneer in Senior Living in India
- 18.79 million sq. ft. area constructed
- 8640 units under maintenance

India's Most  
**Active  
Seniors**

**1488**

**Residents**  
and counting

...that's the number of 55+ senior residents who enjoy an active, healthy and joyous lifestyle at Ashiana Senior Living community, located at Bhiwadi (Delhi NCR), Jaipur and Lavasa



**Ashiana Shubham at Chennai**



India's Most  
**Active  
Seniors**

# 1670

## Activities and counting

...that's the number of activities  
organized for Ashiana Senior  
Living residents in the last 12  
months



Ashiana Shubham at Chennai

India's Most  
**Active  
Seniors**

800

Participants  
and counting

...that's the number of Ashiana Senior Living residents who participate in various activities every WEEK!



Ashiana Shubham at Chennai



At 65, Veena Seth – a trained Kathak dancer continued her passion after 20 years and won prizes for her mesmerizing solo performances



Manju Sachdeva and Sneha Agarwal both 55 who hadn't been on stage since their school days are now the star performers at our in-house functions

## There's Something About Our Seniors...

Mr. Jain (age 85+) came to Ashiana Senior Living on wheel chair and today he can walk with the use of a stick, goes to gym, swim and participates in activities.



60 residents took part in a flash mob at Delhi's most popular mall and surprised everyone





# What an Active Lifestyle means at Ashiana

India's Most

**Active  
Seniors**



**“Growing old is inevitable  
but it is Ashiana  
Senior Living that has  
made it a joyful, smooth  
and sparkling experience  
for both of us.”**

Mrs. & Mr. Sharma  
Ashiana Senior Living, Jaipur

Ashiana Shubham at Chennai

# To your Health and Well-being...

India's Most

Active  
Seniors



“We came here with many health issues but after spending 2 years in open & pollution free environment, we feel much better.”

Mrs. & Mr. Vohra  
Ashiana Senior Living, Bhiwadi

- Ambulance
- Medical assistance center with doctors
- Space for Pharmacy
- Home delivery of medicines
- Yoga and Meditation
- Music Therapy
- Art Therapy

Ashiana Shubham at Chennai



# As Safe and Secure as a Home Should be

India's Most

Active  
Seniors



“Gradually I experienced the safety, security of Ashiana Senior Living that enabled me to be out of station for months without hesitation.”

Mr. Ashok Dewanjee  
Ashiana Senior Living, Bhiwadi

- Emergency response system in each unit
- Secured gated community with CCTV
- Intercom in each unit
- Security staff on duty 24-hours a day
- Liaison with local police and civil administration
- Identity cards are issued to all maids/drivers/vendors to check their entry and exit



Ashiana Shubham at Chennai



# Hassle Free Living at Ashiana Senior Living

India's Most  
**Active  
Seniors**

“We do not have to go outside for work pertaining to electricity, plumbing etc. as the same are attended by Ashiana maintenance dept.”

Mr. Ram Niwas Jain  
Ashiana Senior Living, Bhiwadi

- Maintenance Services
- Convenience Store
- Housekeeping Services
- Bill pay services
- Generator backup for all apartments, common areas and lift
- Ample water supply
- Shuttle service
- Resale & rental service

Ashiana Shubham at Chennai



# Dining Facilities

India's Most

Active  
Seniors



“Whenever my son comes to visit us, he never allows us to prepare food at home. Instead all of us enjoy food in the café.”

Mr. Ram Niwas Jain  
Ashiana Senior Living, Bhiwadi



- Central Dining Hall
- Pure vegetarian food
- Home delivery services
- Cafe
- Kitchen in each apartment with piped gas

Ashiana Shubham at Chennai

# Continuous Care Retirement Community

India's Most  
**Active  
Seniors**

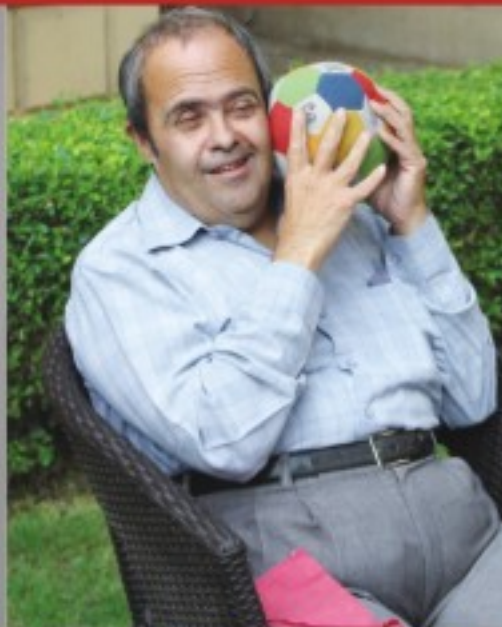

**“I shifted my mother (93) to carehomes as she was suffering from problems like urine incontinency, hypotension, indigestion, sleeplessness. With regular care by trained staff, there was remarkable change in her condition resulting into sound sleep & now her blood pressure, motion, digestive problems all are in control.”**

*Mrs. Jaikishori Kak  
Daughter of Mrs. Bimla Buthoo - Resident of Ashiana Care Homes, Bhiwadi*



- Short stay for recovery
- Dementia and Alzheimer care
- Intergenerational activities
- Trained staff
- Planned activities
- Emergency care
- Physiotherapy

**Ashiana Shubham at Chennai**



# Ashiana Shubham Location

India's Most  
**Active  
Seniors**

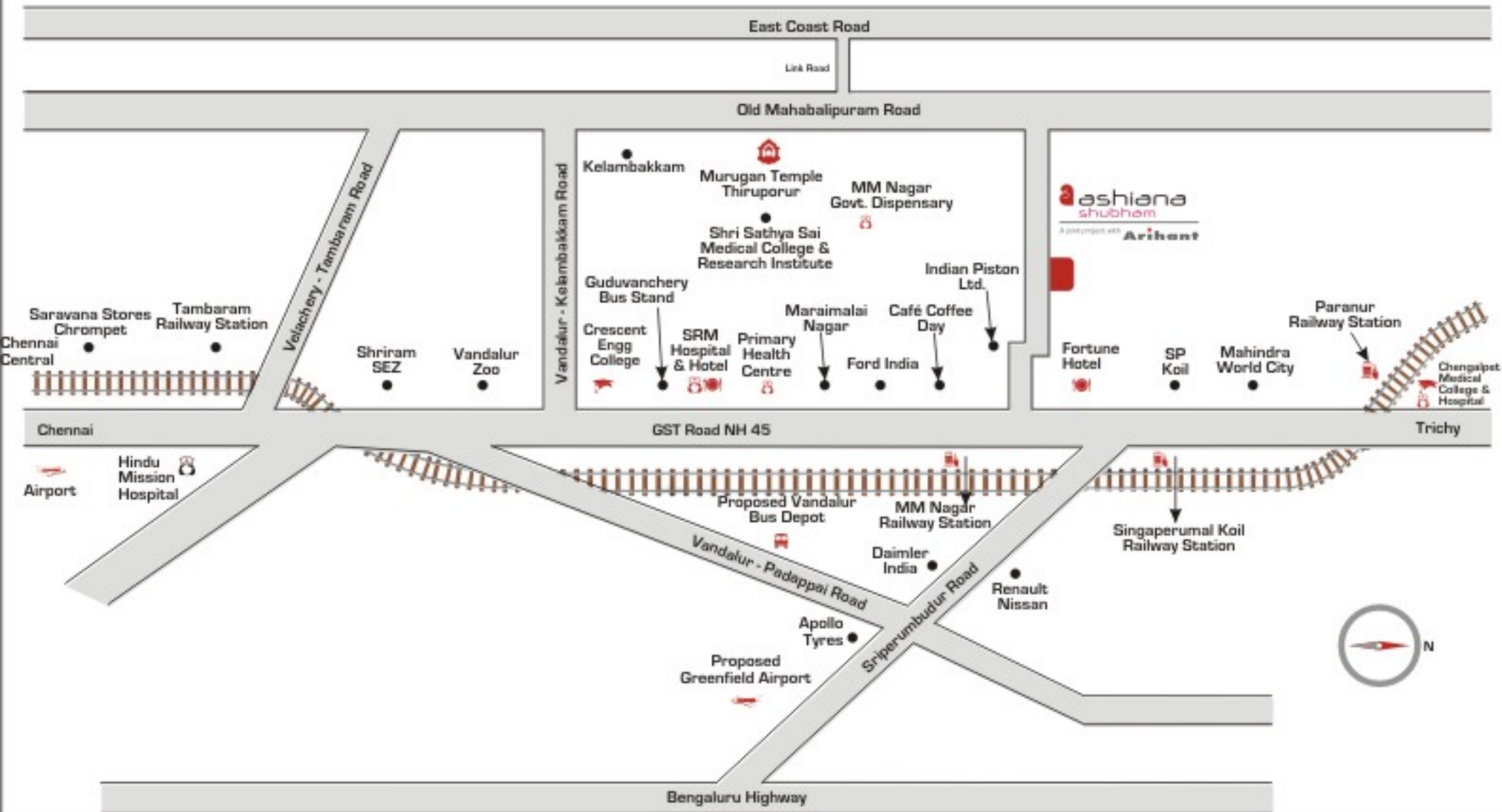

Ashiana Shubham at Chennai

# Ashiana Shubham Site Layout

India's Most  
**Active  
Seniors**



Ashiana Shubham at Chennai



# Tulsi 1 (3 Bedrooms + Puja/Store)

India's Most  
**Active  
Seniors**

Super Built-up Area = 1400 sq. ft. (130.06 sq. mts.)

Built-up Area = 1256 sq. ft. (116.69 sq. mts.)

Built-up Area = Super built-up area - 10.28%

(1 Sq. mt. = 10.764 sq. ft.)



**Important to know:** These plans are for representation purposes only and do not form a part of any agreement or legal binding on part of company. Internal dimensions are as per brick to brick. Balcony dimensions are up to the edge of balcony slab. Tiles/granite can have inherent colour, grain variations and may vary from batch to batch. The floor plan is tentative and subject to variation and modification as decided by the Company/ Architect. For updated floor plans visit our website [ashianahousing.com](http://ashianahousing.com)

**Ashiana Shubham at Chennai**

# Tulsi 2 (3 Bedrooms + Puja/Store)

India's Most  
**Active  
Seniors**

**Super Built-up Area = 1534 sq. ft. (142.51 sq. mts.)**

**Built-up Area = 1390 sq. ft. (129.13 sq. mts.)**

Built-up Area = Super built-up area - 9.40%  
(1 Sq. mt. = 10.764 sq. ft.)



**Important to know:** These plans are for representation purposes only and do not form a part of any agreement or legal binding on part of company. Internal dimensions are as per brick to brick. Balcony dimensions are up to the edge of balcony slab. Tiles/granite can have inherent colour, grain variations and may vary from batch to batch. The floor plan is tentative and subject to variation and modification as decided by the Company/Architect. For updated floor plans visit our website [ashianaahousing.com](http://ashianaahousing.com)

## Ashiana Shubham at Chennai



# Manjari 1 (2 Bedrooms + Puja/Store)

India's Most  
**Active  
Seniors**

**Super Built-up Area = 1156 sq. ft. (107.40 sq. mts.)**

**Built-up Area = 1017 sq. ft. (94.48 sq. mts.)**

Built-up Area = Super built-up area - 12.02%  
(1 Sq. mt. = 10.764 sq. ft.)



**Important to know:** These plans are for representation purposes only and do not form a part of any agreement or legal binding on part of company. Internal dimensions are as per brick to brick. Balcony dimensions are up to the edge of balcony slab. Tiles/granite can have inherent colour, grain variations and may vary from batch to batch. The floor plan is tentative and subject to variation and modification as decided by the Company/Architect. For updated floor plans visit our website [ashianaahousing.com](http://ashianaahousing.com)

**Ashiana Shubham at Chennai**

# Manjari 2 (2 Bedrooms + Puja/Store)

India's Most  
**Active  
Seniors**

**Super Built-up Area = 1298 sq. ft. (120.58 sq. mts.)**

**Built-up Area = 1159 sq. ft. (107.67 sq. mts.)**

Built-up Area = Super built-up area - 10.70%

(1 Sq. mt. = 10.764 sq. ft.)



**Important to know:** These plans are for representation purposes only and do not form a part of any agreement or legal binding on part of company. Internal dimensions are as per brick to brick. Balcony dimensions are up to the edge of balcony slab. Tiles/granite can have inherent colour, grain variations and may vary from batch to batch. The floor plan is tentative and subject to variation and modification as decided by the Company/Architect. For updated floor plans visit our website [ashianaahousing.com](http://ashianaahousing.com)

**Ashiana Shubham at Chennai**



# Vrinda 2 (1 Bedroom)

India's Most  
**Active  
Seniors**

**Super Built-up Area = 581 sq. ft. (53.98 sq. mts.)**

**Built-up Area = 484 sq. ft. (44.96 sq. mts.)**

Built-up Area = Super built-up area - 16.70%

[1 Sq. mt. = 10.764 sq. ft.]



**Important to know:** These plans are for representation purposes only and do not form a part of any agreement or legal binding on part of company. Internal dimensions are as per brick to brick. Balcony dimensions are up to the edge of balcony slab. Tiles/granite can have inherent colour, grain variations and may vary from batch to batch. The floor plan is tentative and subject to variation and modification as decided by the Company/Architect. For updated floor plans visit our website [ashianaahousing.com](http://ashianaahousing.com)

**Ashiana Shubham at Chennai**

### **Sales & Site Office:**

Ashiana Shubham  
Villa Viviana (Arihant), Govindapuram,  
Sengundram Hamlet, Melrosapuram Road,  
Maraimalai Nagar, Chennai - 603204  
Ph: 044 2985 4455  
**Shilpi : 97910 02993**

### **Branch Office:**

GJ Complex, Door no, 10,  
1st Main Road, CIT Nagar, Chennai - 600 035  
Ph: 044 4626 2222

© "The content and pictorial shown in the brochure are the proprietary content and material which belongs to the company and any unauthorised circulation, re-use or reproduction of the same will constitute to violation of the copyright."

Disclaimer: This E-brochure is not a legal document. It only describes the conceptual plan to convey the intent & the purpose of Ashiana Shubham. Refer our website for draft maintenance and sale agreement. If you are Unable to locate it, email us at [care@ashianahousing.com](mailto:care@ashianahousing.com)