



Tulip



# TULIP YELLOW

3 BR LUXURY APARTMENTS

*If luxury had a colour, it would be yellow.*

# TULIP. THE REVELATION

We are one of the foremost real-estate developers in Delhi NCR. A name that is awarded with many an accolade from the world over, Tulip Infratech is a shining beacon of truth in an industry that is constantly mired in controversy. Tulip has earned the trust of its customers through timely deliverance of projects. Moreover, we have flourished because we keep our dear customers in mind.

## THE GROUP AT A GLANCE

Established  
in  
**2005**

**15**  
Projects  
Handed over

Developed  
Land of  
**95+** Acres

**5000+**  
Happy Families  
residing

## ACCOLADES



NAREDCO



REALTY FACT



ALL INDIA HUMAN  
WELFARE



NAREDCO



BUILDER INFORMATION  
BUREAU (BIB)



RAJIV GANDHI  
MEMORIAL NATIONAL AWARD

## Our Completed Projects in Sector 69-70

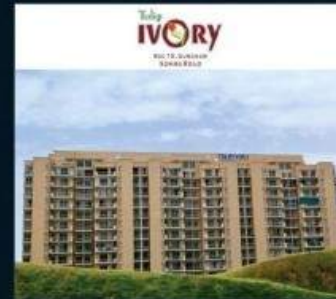

## Projects under construction

**Tulip Leaf**  
A new way of luxury living  
3BHK APARTMENTS | SEC 69, GURGAON





**TULIP YELLOW**

3 BR LUXURY APARTMENTS

THE LATEST  
UNPARALLELED OFFERING  
FROM THE EXCLUSIVE HOUSE  
OF TULIP.

---













**TULIP YELLOW**

3 BR LUXURY APARTMENTS

## MADE TO MAKE YOU FEEL LIKE A KING

---

*J*og your way to that marathon. Practice yoga like an ancient sage. Or, blow up world records with that incredible six. After all has been done, lay back and unwind; enjoy the peace of mind that only safe living can provide. Indulge yourself in abundant activities and relaxation! Here at Tulip, we recognize that your family deserves a healthy and holistic lifestyle.

- Jogging track
  - Yoga pavilion
  - Cricket pitch
  - Kids play area
  - Gym
  - Swimming pool with lounge deck
  - Tennis court
  - 'Multipurpose' Court
  - Earthquake resistant
  - High-speed elevators
  - Badminton Court
  - Skating Ring
  - Meditation Garden
  - Picturesque landscaping with water features
  - Independent clubhouse
  - In-house convenience shopping
  - Coffee Shop
  - Golf cart available on site on request for residents
  - Zero Vehicle Movement at Ground Level
  - Wi-fi Zone
  - Occupancy light sensor in the drawing room
-

























**TULIP YELLOW**

3 BR LUXURY APARTMENTS

## IT'S CALLED LUXURY LIVING!

---

*E*very apartment at Tulip Yellow is an ode to good living. Adorned with a plethora of amenities, crafted to let positivity flow from all sides, designed to pamper the snob in you, each magnificent home here, is bright and happy from inside.

---



















**TULIP YELLOW**

3 BR LUXURY APARTMENTS

## SAFE AND SOUND, FOR YOU TO GO ANYTIME AROUND

---

*W*ith state-of-the-art security devices and a posse of armed guards, at position outside and inside the premises, Tulip Yellow is as safe as a society can be. Be assured. Your beloved ones will be secure while you are out.

- Three layered security
  - CCTV surveillance
  - Provision of Video Door phone  
connected with ground floor lobby  
and main gate.
  - Smoke Detector
  - Fire Sprinkler System
  - Gas Leak Detector
-













**TULIP YELLOW**

3 BR LUXURY APARTMENTS

## A PLACE IN THE MIDDLE OF EVERYWHERE

---

*A*t Tulip Yellow, we take pride in being able to reach anywhere swiftly. Situated in the heart of the Millennium City, it is a stone's throw from the commercial hub, a hop away to the international airport, proximate to prominent hospitals and schools, yet very private and surrounded by greenery. In other words, your safe oasis within a bustling city.

---















5 Min  
Away



**Shopping**

- Tulip Street
- Proposed Tulip Avenue-I

**Entertainment**

- Cafés & Snack Points

**Schools**

- The Vivekananda School

**Transportation**

- Connected to southern peripheral expressway via 60 meter road

**Others**

- Proposed Temple by Tulip
- Proposed Club by Tulip
- Chemists ... and more



10 - 20 Min.  
Away



**Shopping**

- Tulip Avenue-II (modern Shopping Complex)

**Entertainment**

- Multiplex Cinemas
- Cafés & Snack Points
- Fine Dining Restaurants

**Schools**

- Indus world School
- Vibgyor International School

**Transportation**

- Connected to southern peripheral expressway via 60 meter road
- Connectivity to NH48
- Proposed metro in the vicinity

**Others**

- All of Major Bank Branches
- Hospitals & Chemists
- Gym and Spa Centres ... and more



20 - 40 Min.  
Away



**Shopping & Entertainment**

- PVR & Other Multiplex Cinemas
- Luxury and Fine Dining Restaurants
- Café & Clubs
- Amusement Parks
- Shopping Malls

**Schools**

- Heritage School
- Pathways International School
- G. D. Goenka
- Delhi Public School

**Hospitals**

- Medanta Hospital
- Fortis Artemis Hospital

**Transport**

- IGI Airport
- Rapid Metro
- Huda City centre Metro Station
- Railway Station ... and more





## TULIP YELLOW

3 BR LUXURY APARTMENTS

WHERE EVERY  
NOOK AND CORNER  
ADD TO THE PRIDE

---





### LIVING ROOM

**Walls :**  
Acrylic Emulsion  
**Floor:**  
Vitrified Tiles or equivalent  
**Doors :**  
Hardwood door frame with  
Panel Door Shutters  
**Windows / Glazing :**  
Reinforced UPVC or equivalent



### BED ROOMS

**Walls :**  
Acrylic Emulsion  
**Floor:**  
Wooden flooring in all bedrooms  
**Doors :**  
Hardwood door frame with  
Panel Door Shutters  
**Windows / Glazing :**  
Reinforced UPVC or equivalent



### MODULAR KITCHEN

**Walls :**  
2" DADO above counter  
**Floor:**  
Anti-skid ceramic tiles  
**Windows / Glazing :**  
Reinforced UPVC or equivalent  
**Others:**  
Laminated Plywood Modules,  
Laminated MDF shutters with Granite  
Counter & Stainless steel sink



### TOILETS

**Walls :**  
Ceramic Tiles and Acrylic Emulsion  
**Floor:**  
Anti-skid ceramic tiles  
**Doors :** Hardwood door frame with  
Panel Door Shutters  
**Windows / Glazing :**  
Reinforced UPVC or equivalent  
**Others:** White sanitary fixtures, CP fitting  
with hot and cold water mixture and mirror



### BALCONIES

**Walls :**  
Permanent texture / paint finishes  
**Floor:**  
Anti-skid ceramic tiles



### LIFT LOBBIES

**Walls :**  
Permanent texture / paint finishes  
**Floor:**  
Pattern of vitrified / Granite or equivalent  
**Others:** Ground floor lobby with smart lounge



### EXTERNAL FACADE

**Walls :**  
Permanent texture / paint finishes



### SECURITY

Flat to flat intercom facility  
Digital Access for Tower Entry  
Provision for audio/video access at each  
tower's lobby and main gate

# Typical Unit Plan



**UNIT AREA= 1704 SQ.FT./ 158.31 SQ.M.**  
**CARPET AREA= 1034.31 SQ.FT./ 96.09 SQ.M.**  
**BALCONY AREA= 195.14 SQ.FT./ 18.129 SQ.M.**

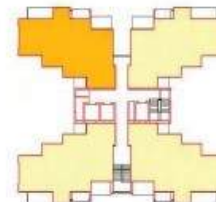

**CLUSTER PLAN**

**Disclaimer:**

The promoters/architects reserve the right to add/ delete any details/ specifications if so warranted by the circumstances.  
 Soft furnishings, furniture and gadgets are not a part of this offering.



# Site Plan



## Location Map



PROPOSED MAP, NOT TO SCALE ONLY FOR INDICATION



**Tulip Infratech Pvt. Ltd.**

Gurgaon Office : 766, Sector-18, Gurgaon - 122 015 (Haryana)

E-mail: [info@tulipgroup.in](mailto:info@tulipgroup.in)

Disclaimer: This brochure is purely conceptual and not a legal offering. The promoters/developers reserve the right to add/delete any details/specifications if so warranted by the circumstances. Soft furnishing, furniture and gadgets are not part of the offering.

RERA REGN. NO. 70 of 2019 dt. 14.11.2019